

LED BEACONS

SKH-M2JB-B

LED rotation beacon, IP23, Ø100mm 100-240V AC, cable/buzzer/blue

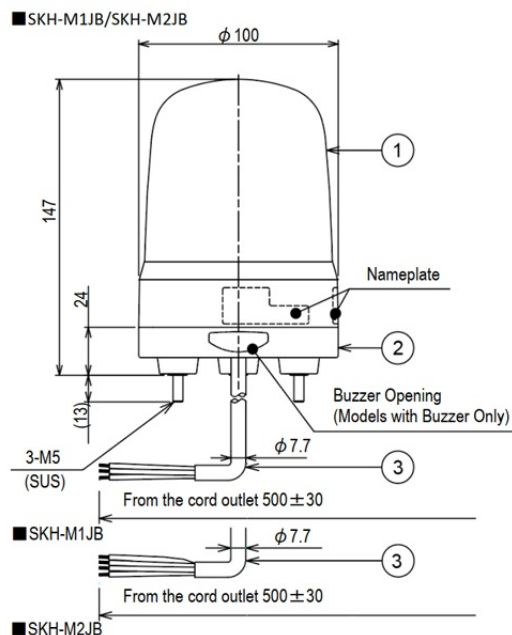

Specifications

Brand	Patlite	Mounting and connection type	3-screw mounting/cable
Buzzer	Yes	Operating temperature	-10°C to +50°C
CE certificate	Yes	Operating voltage	90-250V AC
Cable length	500mm	Particularities	Rotates 120x/minute
Certificates, quality marks, markings	CE, cULus, EAC, KC	Rated current	100V AC 0,08A / 240V AC 0,05A
Colour lens	Blue	Rated voltage	100-240V AC (50/60Hz)
Dimensions	Ø100mm x 147mm	Relative humidity	Less than 90% (no condensation) at 20°C
Impact resistance	4,5G	Sound level (max.)	88dB
Ingress protection	IP23 / IP65 with rubber gasket	Type	Pre-configured
LED life	100 000h	Type	Pre-configured
Light patterns	Rotating	UL certificate	Yes
Luminous intensity	4400cd	Voltage	115V AC / 230V AC
Material	Polycarbonate	Weight	370g